

OVERVIEW OF ALL CONTROLS

Control board

Control board and app are always included in the delivery.

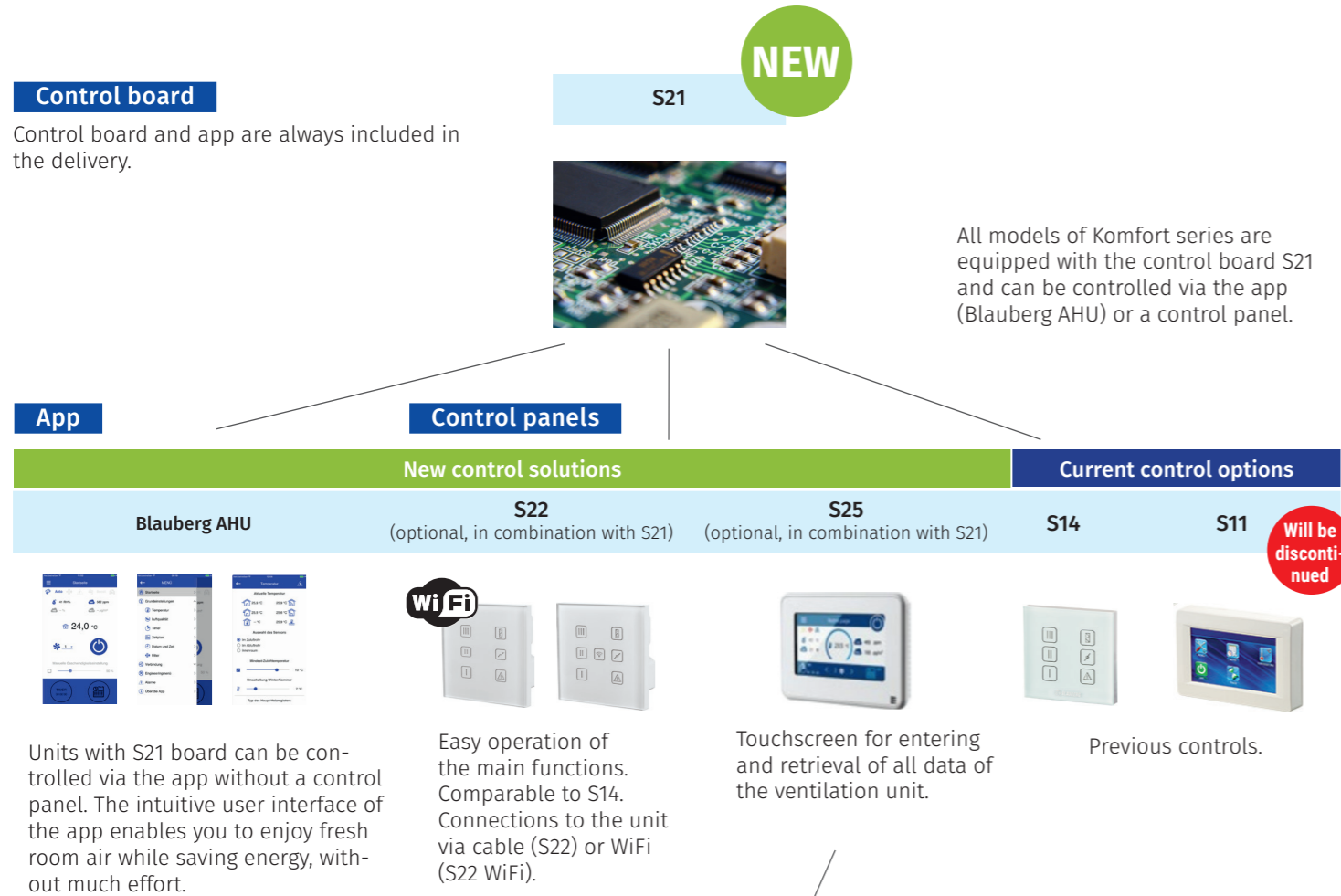

Komfort units

Model	New control solutions		Current control options
	S21 + APP (always included in delivery) Can be controlled with S22, S22 WiFi, S25 or the app "Blauberg AHU".		S14
KOMFORT ROTO EC S	•		
KOMFORT EC LB	•		•
KOMFORT EC S/SB *	•		•
KOMFORT EC D5B	coming soon		•
KOMFORT EC S5B	coming soon		•
KOMFORT EC DB	•		•
KOMFORT EC DE	coming soon		
KOMFORT EC DW	coming soon		

* Except for KOMFORT EC S(B)200 and KOMFORT EC S250 (S14 only)

Control board S21

Functions and compatibilities	S21 + APP (always included in delivery)
WiFi control of the unit via app	+
Control via control panel, connection via cable	Control panel S22 (optional)
Control via LCD control panel, connection via cable	Control panel S25 (optional)
Control via wireless control panel, connection via WiFi	Control panel S22 WiFi (optional)
Speed selection	+
Filter replacement indication	according to filter timer
Alarm indication	full alarm description with history
Week-scheduled operation	+
Timer	+
Bypass control	automatic or manual
Boost-Mode	+
Fireplace mode	+
Frost protection by cyclic switch-off of the supply fan	optional preheating, controllable
Connection of a post-heating coil	optional postheating, controllable
Connection of a cooling coil	optional cooling register, controllable
Monitoring of the minimal supply air temperature	+
Humidity control	optional
CO ₂ control	optional
VOC control	connectable, not part of Blauberg product range
PM2.5 control	connectable, not part of Blauberg product range
Fire alarm sensor connection	connectable, not part of Blauberg product range
Integration in BMS	+



Blauberg AHU
Download app for iOS



Blauberg AHU
Download app for Android



Info

The S22/S22 WiFi and S14 control panels are designed for use by the end user. The professional settings are always retrievable in the app.

Comparison external control panels

All functions are always retrievable in the app.

Functions	S25 control	S11 control (previous control panel)	S22 control / WiFi	S14 control (previous control panel)
WiFi control of the unit via mobile app	+	-	+	-
Alarm indication	full alarm description	error code only	LED alarm indication	LED alarm indication
Week-scheduled operation	+	+	-	-
Timer	+	+	-	-
Boost mode	+	-	-	-
Bypass control	automatic or manual	automatic or manual	manual control only (via app automatic)	manual control only
Frost protection by cyclic switch-off of the supply fan	optional preheating, controllable	+	+	+
Connection of a post-heating coil	optional postheating, controllable	+	+	+
Connection of a cooling coil	optional cooling register, controllable	+	+	+
Monitoring of the minimal supply air temperature	+	+	-	-
Humidity control	optional	optional	-	-
CO ₂ control	optional	-	-	-

optional: This function is available when respective accessory (see accessories) is used.

Additional functions of S14 control with installed PC software:

- Setting of the required speed from 0 to 100 %. Every speed level of the supply and exhaust fan is adjusted individually during setup.
- Control according to the signal of duct humidity sensor FS2 or of another connected sensor, like a CO₂ sensor, air quality sensor etc. (separate order).
- Operation setting according to external control device (separate order).

- Setting of setpoint temperature for freezing protection of the heat exchanger.
- Control and setting of the maintenance interval via filter timer.
- Control of the external control device, bypass and room humidity control.

With the new controls this step is not necessary anymore, as all settings can be easily done via the app.